

OUTPUT SHAFT COUPLING & PROPELLER COUPLING DIMENSION

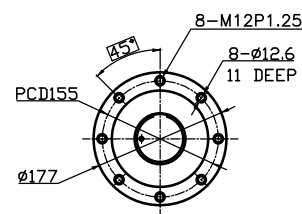

INPUT COUPLING DIMENSION

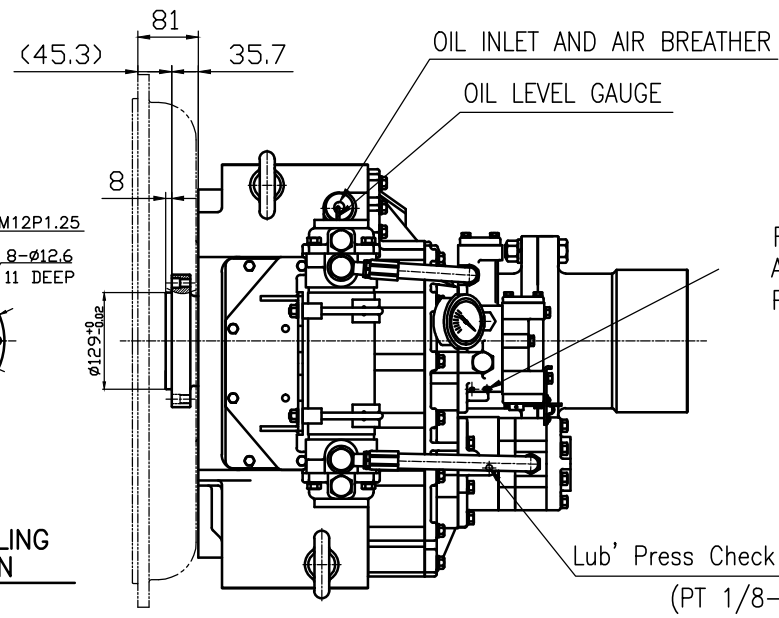

DMT260H MARINE TRANSMISSION SPECIFICATION			
GEAR RATIO	2.06, 2.50, 2.92, 3.26		
TOTAL WEIGHT	APPROX. 490 Kg(DRY)		
OIL CAPACITY	APPROX. 8 L		
OIL VISCOSITY	SAE # 30		
OIL PRESSURE	1.96 ~ 2.54 MPa	CLUTCH OIL	
DIRECTION OF ROTATION	INPUT	C.C.W VIEWED FROM THE STERN	
	OUTPUT	C.W VIEWED FROM THE STERN	
OIL CHANGE INTERVAL	THE FIRST 100HOURS OF INITIAL OPERATION AND EVERY 1000HOURS THEREAFTER		
SHIFTING LIMIT	UNDER 50% OF THE RATED ENGINE SPEED		
OIL COOLER	WATER FLOW 60 ~ 80 L/min		TEMPERATURE OF COOLING WATER MAX 32°C
	OPERATING TORQUE OF SHIFTING LEVER		

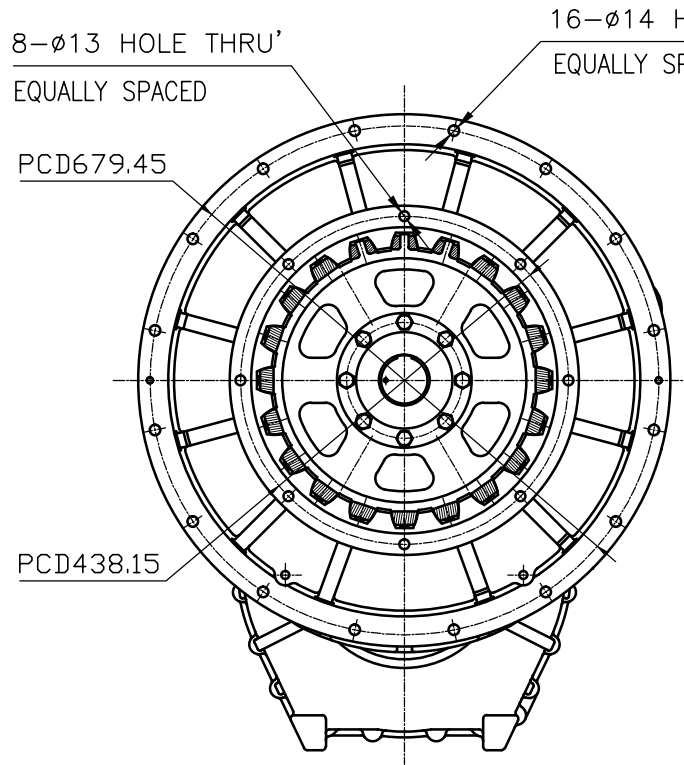

REMARK
1.HOUSING: SAE#0
2.DRIVING RING: SAE 14"
3.COULING TYPE : RUBBER

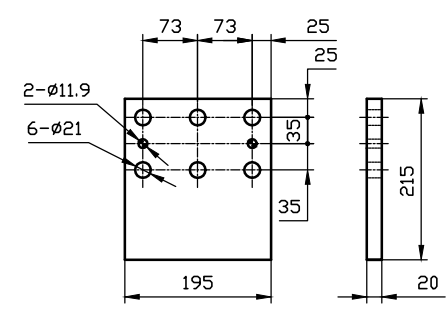

BRACKET DIMENSION

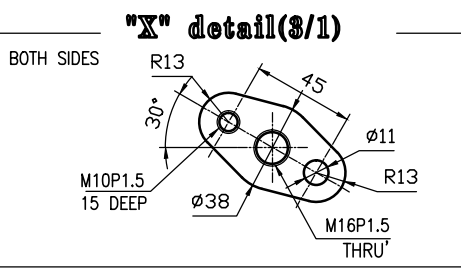

CLEARANCE TO REMOVE OIL SUCTION STRAINER

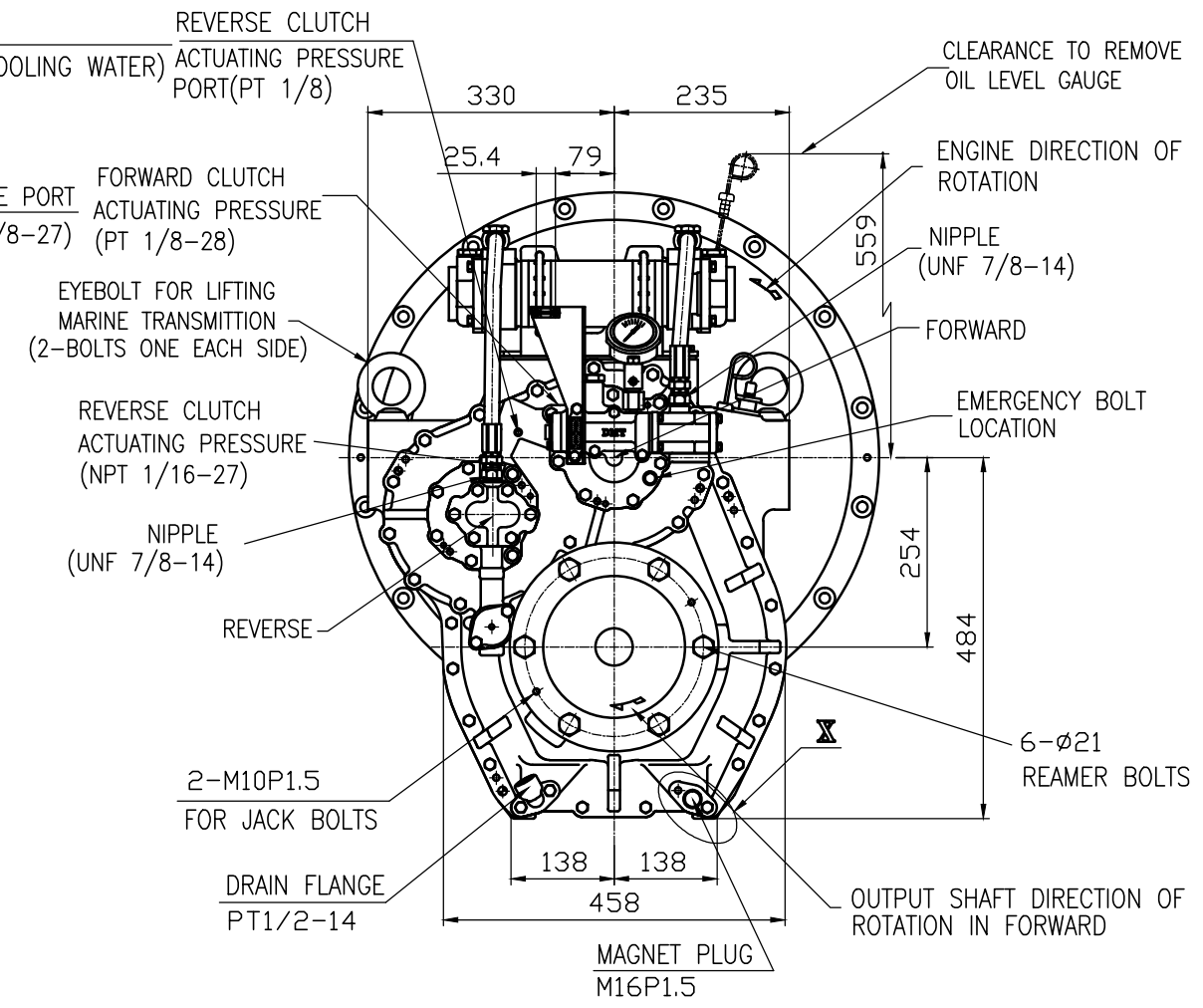

公差表 TOLERANCE ON				번호 NO.	품명 PART NO.	품명 PART NAME	개수 QTY	재질 MATERIAL	규격 SIZE	비고 REMARKS
분수 FRACTIONS	소수 DECIMALS	각도 ANGLES	±	제 MATERIAL	작성 DATE	척도 SCALE	형식 TYPE	원도 번호 ORIGINAL DWG. NO.	품명 NAME	계량 (REV.)
±	±	±	±	2013.02.12	1/1	DMT260H	MARINE TRANSMISSION	25000GA~D-014RC	000	
1초과 4 이하	±0.3	±0.1	±0.05	승인 APPROVED BY	검토 CHECKED BY	제도 DRAWN	설계 DESIGNED	도 번호 DWG. NO.	25000GA~D-014RC	000
4	±0.5	±0.2	±0.07	JK.Kim	KS.Han	KC.Yoon		크기 SIZE	A 3	코드 번호 CODE ID. NO.
16	±0.7	±0.3	±0.1	D-I INDUSTRIAL						
63	±1.2	±0.5	±0.2							
250	±2.0	±0.8	±0.3							